

Waterproof pre-insulated hexagonal compression connectors

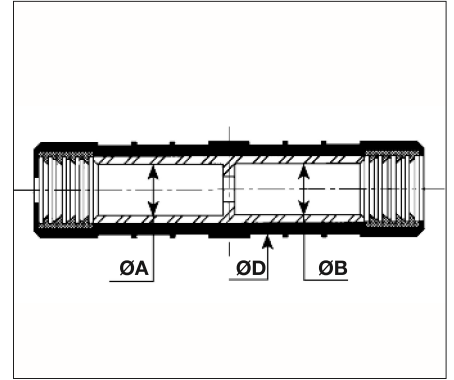
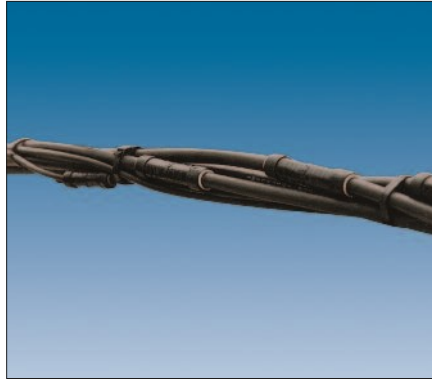

Type: **MJPT**

Application

These pre-insulated connectors are suitable for insulated stranded aluminium conductors. Three connector versions are available to meet the mechanical load requirements for self-supporting system and systems with a neutral messenger. Stripped cables are inserted up to the block in the connector. Crimping according to the marks with appropriate crimping die over the insulation. The electrical contact and the sealing by the elastomeric ring are achieved during the crimp process. Uniform connector length of 100 mm, except for neutral messengers 170 mm.

Features

- Suitable for stranded aluminium conductors
- Tested for water tightness at a voltage of 6 kV for 30 min in a waterbath (NFC 33020, CENELEC prEN 50483-4 class 1)
- Only two crimping die sizes (E173, E215) cover complete connector range (tools and dies see pages 52 and 53)
- Exceeds requirements according to CENELEC prEN 50483-4 class 1, NFC 33021 and ESI 43-14
- A colour code of elastomeric sealing ring allows an easy identification of the cross sections
- Inner aluminium sleeve filled with contact grease
- Insulation material made of weather and UV resistant polymer

Mechanical load withstand of connectors:

- For conductors of self-supporting system: 85 % of conductor breaking load
- For systems with neutral messenger: 60 % of breaking load of phase conductor
95 % of breaking load of insulated neutral conductor

Waterproof pre-insulated hexagonal compression connectors

Cross section (mm ²)	Ordering description	Colour code A/B	Dimensions (mm)			Crimp die size	Weight (kg/100 pcs)
			ØA	ØB	ØD		
For self supporting LV-ABC systems							
16	MJPT 16	blue	5,5	5,5	20	E173	5,5
25	MJPT 25 Alus	orange	6,5	6,5	20	E173	5,5
35	MJPT 35 Alus	red	—	—	—	E173	5,5
50	MJPT 50 Alus	yellow	9,0	9,0	20	E173	5,0
70	MJPT 70 Alus	white	10,5	10,5	20	E173	4,5
95	MJPT 95 Alus	grey	12,2	12,2	25	E215	7,5
120	MJPT 120 Alus	pink	14,2	14,2	25	E215	7,5
For phase conductors of LV-ABC systems with neutral messenger							
16	MJPT 16	blue	5,5	5,5	20	E173	5,5
25	MJPT 25	orange	6,5	6,5	20	E173	5,0
35	MJPT 35	red	8,0	8,0	20	E173	5,0
35 – 25	MJPT 35-25	red/orange	8,0	6,5	20	E173	5,0
50	MJPT 50	yellow	9,0	9,0	20	E173	5,0
50 – 25	MJPT 50-25	yellow/orange	9,0	6,5	20	E173	5,0
50 – 35	MJPT 50-35	yellow/red	9,0	8,0	20	E173	5,0
70	MJPT 70	white	10,5	10,5	20	E173	4,5
70 – 35	MJPT 70-35	white/red	10,5	8,0	20	E173	4,5
70 – 50	MJPT 70-50	white/yellow	10,5	9,0	20	E173	4,5
95	MJPT 95	grey	12,2	12,2	20	E173	4,0
95 – 35	MJPT 95-35	grey/red	12,2	8,0	20	E173	4,5
95 – 50	MJPT 95-50	grey/yellow	12,2	9,0	20	E173	4,0
95 – 70	MJPT 95-70	grey/white	12,2	10,5	20	E173	4,0
120	MJPT 120 D25	pink	14,2	14,2	25	E215	8,5
150	MJPT 150	violet	15,5	15,5	25	E215	8,0
150 – 70	MJPT 150-70	violet/white	15,5	10,5	25	E215	9,0
150 – 95	MJPT 150-95	violet/grey	15,5	12,2	25	E215	9,0
For insulated neutral conductors of LV-ABC systems with neutral messenger							
54,6	MJPT 54	black	10,0	10,0	20	E173	8,0
70	MJPT 70N	white	10,5	10,5	20	E173	8,0
70 – 54,6	MJPT 70N-54	white/black	10,5	10,0	20	E173	8,0